

Figure 1-1 Illustrated Parts Breakdown (FRONT CASE Relation)

- (NOTE)
- When assembling #4, tighten #13 screws at 35.0cN·m (3.6kgf·cm) of tightening torque. (Two places.)
  - When assembling #6, tighten #13 screws at 35.0cN·m (3.6kgf·cm) of tightening torque. (Four places.)

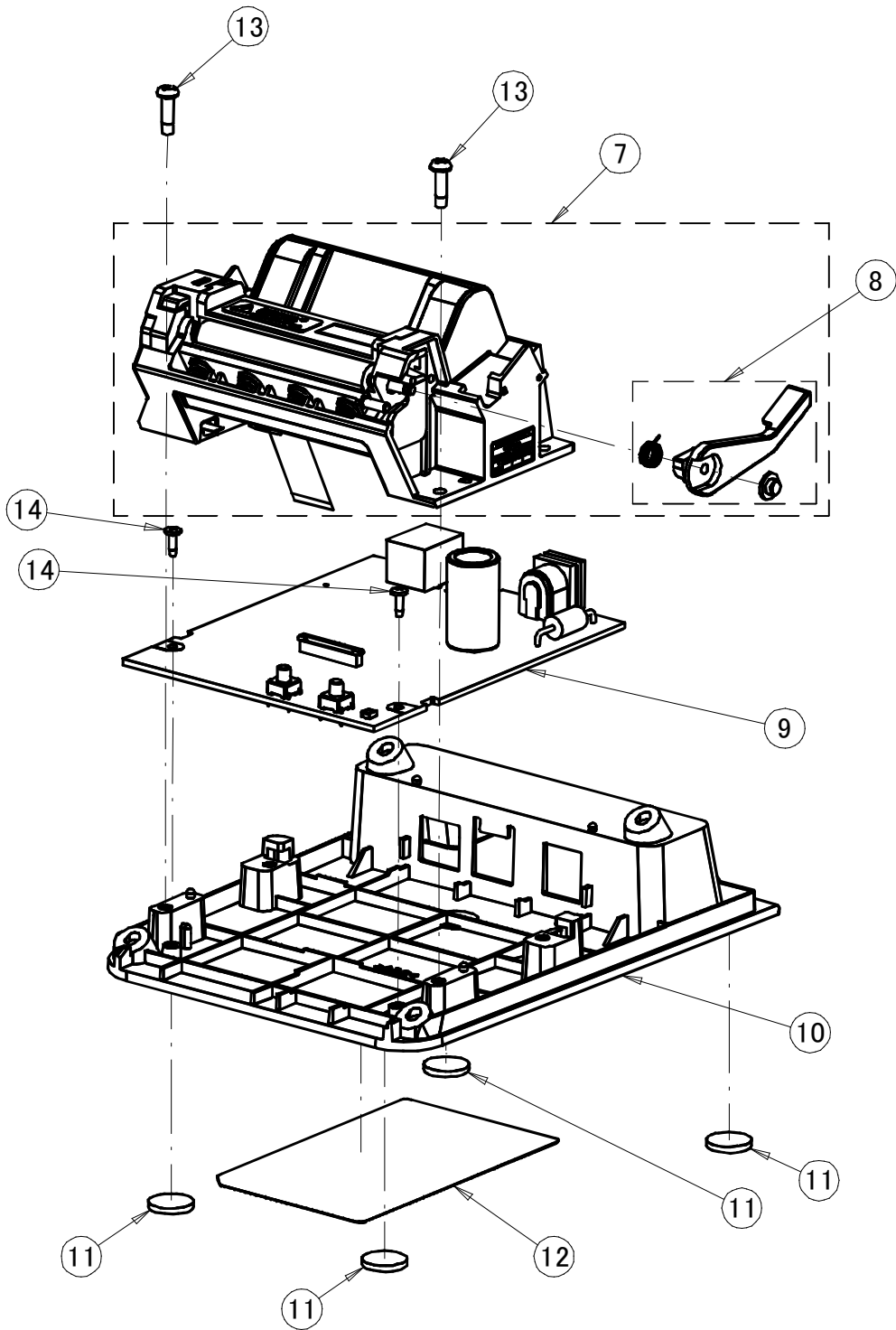

Figure 1-2 Illustrated Parts Breakdown (BOTTOM CASE Relation)

- (NOTE)
- #7 and #9 are connected by FPC. When disassembling, be careful not to break FPC.
  - When assembling #7, tighten #13 screws at 35.0 cN·m (3.6kgf·cm) of tightening torque. (Two places.)
  - When assembling #9, tighten #14 screws at 14.7 cN·m (1.5kgf·cm) of tightening torque. (Two places.)

**Table 1-1 Parts List**

<b>No.</b>	<b>Parts No.</b>	<b>Parts Name</b>	<b>Qty.</b>	<b>Notes</b>
1	U001284243XX	ROLL COVER	1	
2	U001284232XX	SPINDLE	1	
3	U001284208XX	PRINT ENGINE COVER	1	SLP620
	U001284210XX			SLP650
	U001284221XX			SLP650SE
4	U001284186XX	REAR CASE	1	
5	U001284118XX	PINCHER UNIT	1	
6	U001283995XX	FRONT CASE UNIT	1	SLP620,SLP650SE(WHITE)
	U001284006XX		1	SLP650(BLACK)
7	U001283613XX	MECHA BLOCK	1	SLP620
	U001283894XX		1	SLP650,SLP650SE
8	U001293311XX	RELEASE LEVER UNIT	1	
9	U001285132XX	MAIN PCB BLOCK	1	SLP620
	U001285143XX		1	SLP650
	U001285154XX		1	SLP650SE
10	U001284085XX	BOTTOM CASE	1	
11	U001284096XX	RUBBER FOOT	4	
12	U001293287XX	PRODUCT LABEL	1	SLP620
	U001293298XX		1	SLP650
	U001293300XX		1	SLP650SE
13	U001284107XX	CROSS-RECESSED PANHEAD SCREW	8	B-TITE 3*10 NI
14	U001284063XX	CROSS-RECESSED BINDING-HEAD SCREW	2	B-TITE 2*6 NI